

NOTE: FIXING ANGLES CAN BE FACING OUT DEPENDING ON STRUCTURE DEPTH

NOTE: STANDARD FRAME CAN ALSO BE USED

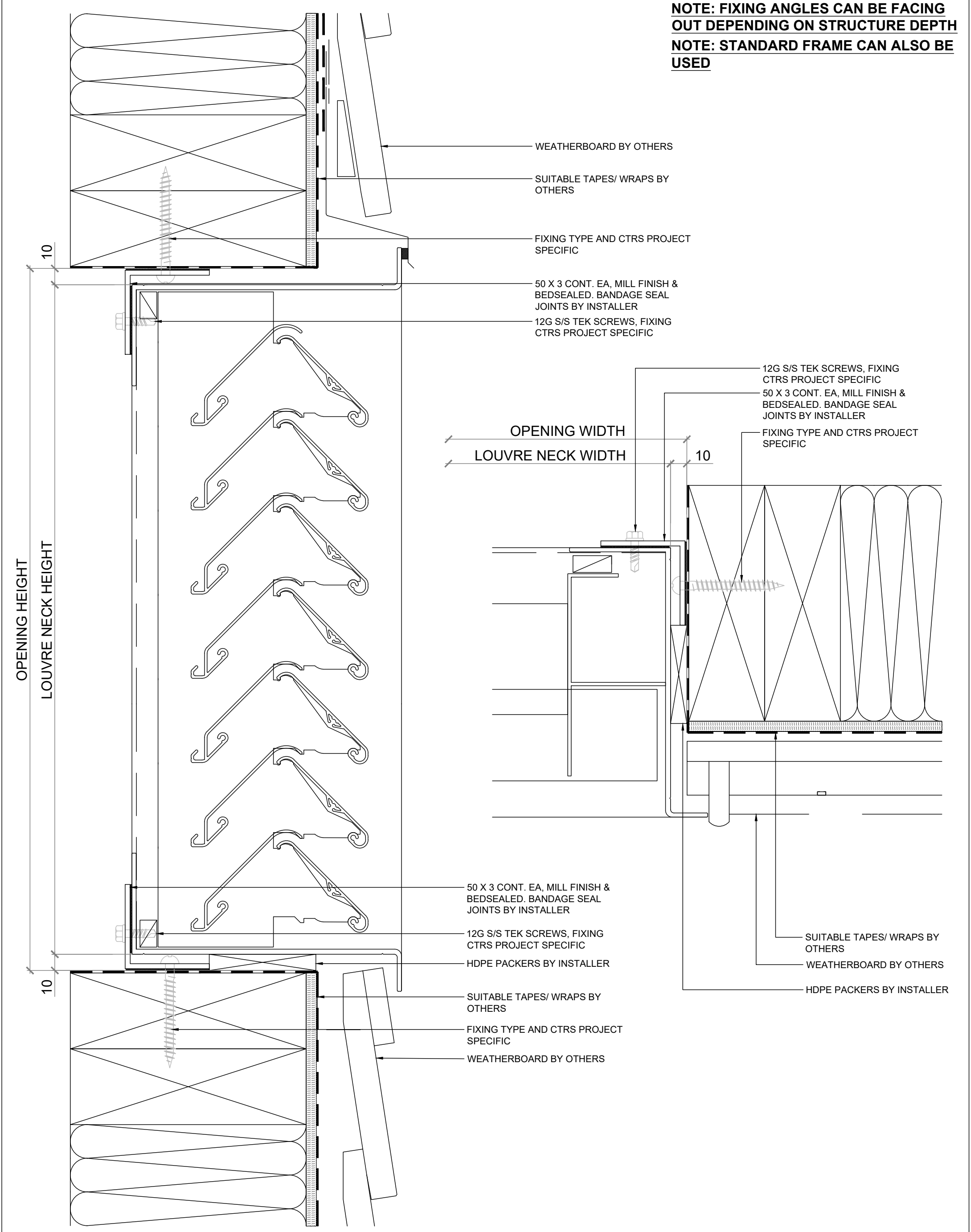

VENTILATION LOUVRE
VL-2SD
INSTALLATION DETAIL WEATHERBOARD



VENTÜER

Ventilation, Acoustic & Smoke Louvres

E: sales@ventuer.co
W: ventuer.co

© 2019 All rights reserved

SCALE: 1:2 @ A3 - 1:1 @ A4	
DWG NO. VL-2SD-A.10	
DATE: 15/01/2025	REV 1