

NOTE: FIXING ANGLES CAN BE FACING OUT DEPENDING ON STRUCTURE DEPTH

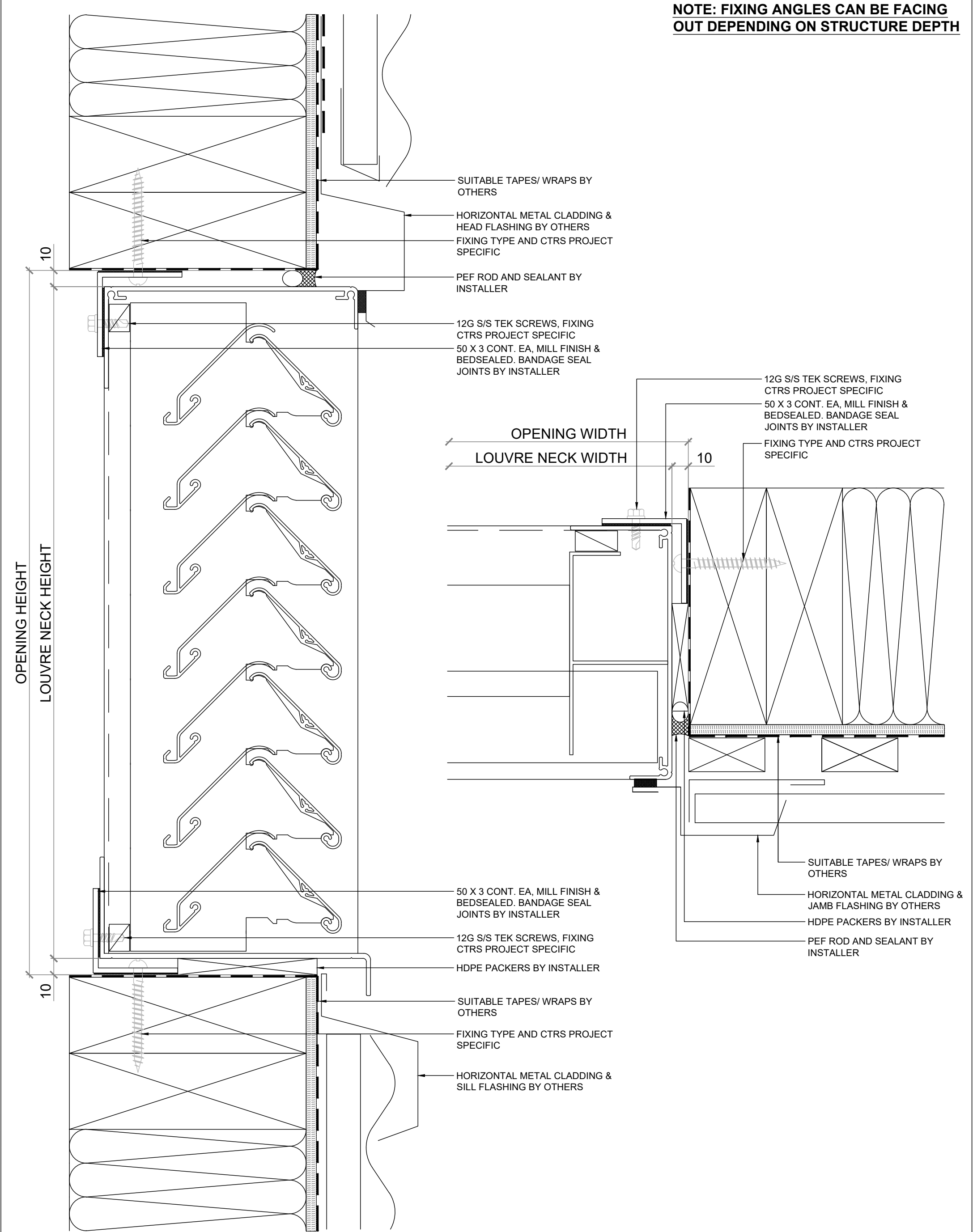

VENTILATION LOUVRE
VL-2SD
INSTALLATION DETAIL HORIZONTAL METAL CLADDING



# VENTÜER

Ventilation, Acoustic & Smoke Louvres

E: sales@ventuer.co  
W: ventuer.co

© 2019 All rights reserved

SCALE: 1:2 @ A3 - 1:1 @ A4
DWG NO. VL-2SD-A.05
DATE: 15/01/2025
REV 1