

**NOTE: FIXING ANGLES CAN BE FACING IN  
DEPENDING ON STRUCTURE DEPTH**  
**NOTE: 25MM FLANGE OPTION AVAILABLE**

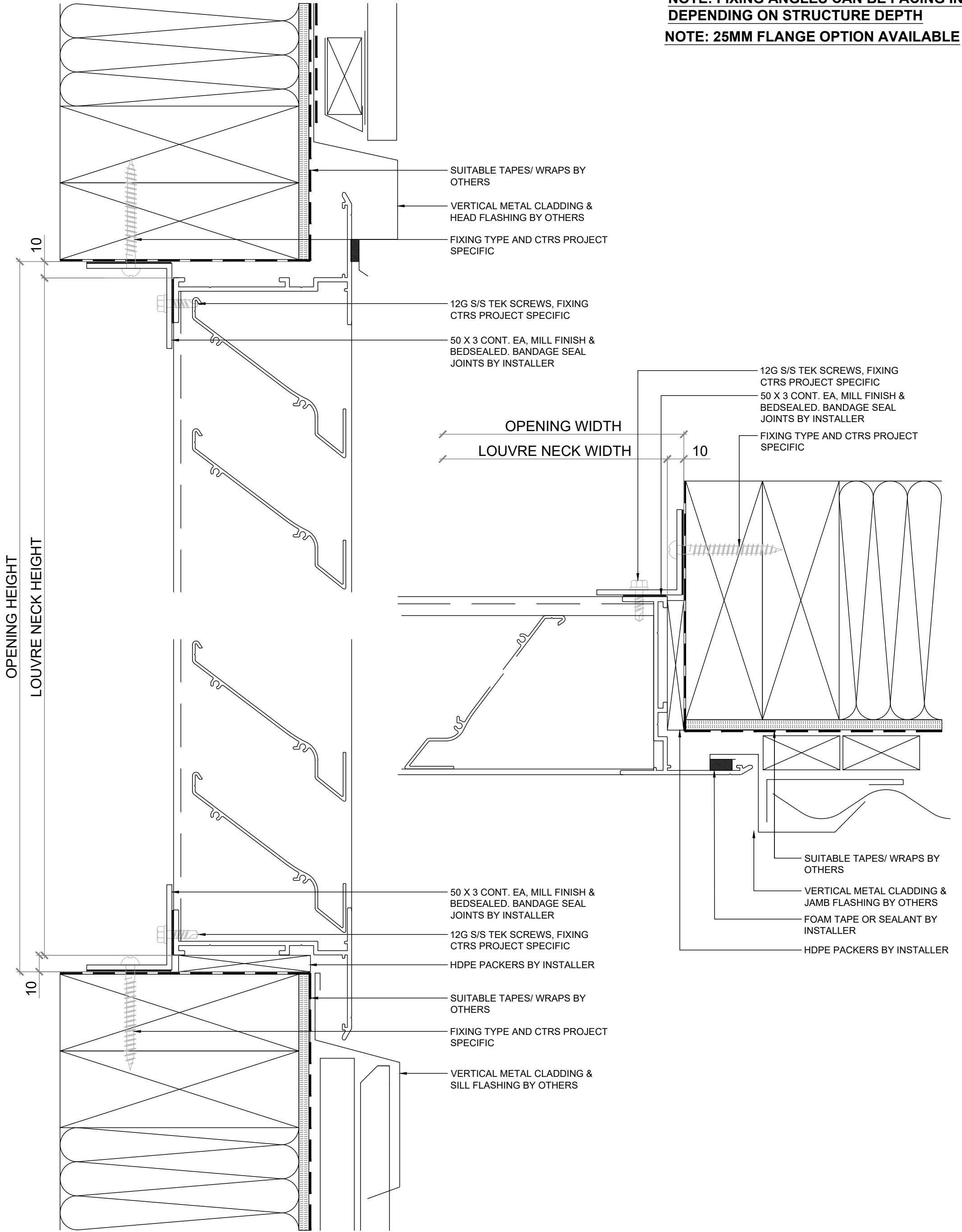

VENTILATION LOUVRE
VL-104D
INSTALLATION DETAILS VERTICAL METAL CLADDING



# VENTÜER

Ventilation, Acoustic & Smoke Louvres

E: sales@ventuer.co  
W: ventuer.co

© 2019 All rights reserved

SCALE: 1:2 @ A3 - 1:1 @ A4	
DWG NO. VL-104D-A.04	
DATE: 15/01/2025	REV 1