

**NOTE: FIXING ANGLES CAN BE FACING IN
DEPENDING ON STRUCTURE DEPTH**
NOTE: 25MM FLANGE OPTION AVAILABLE

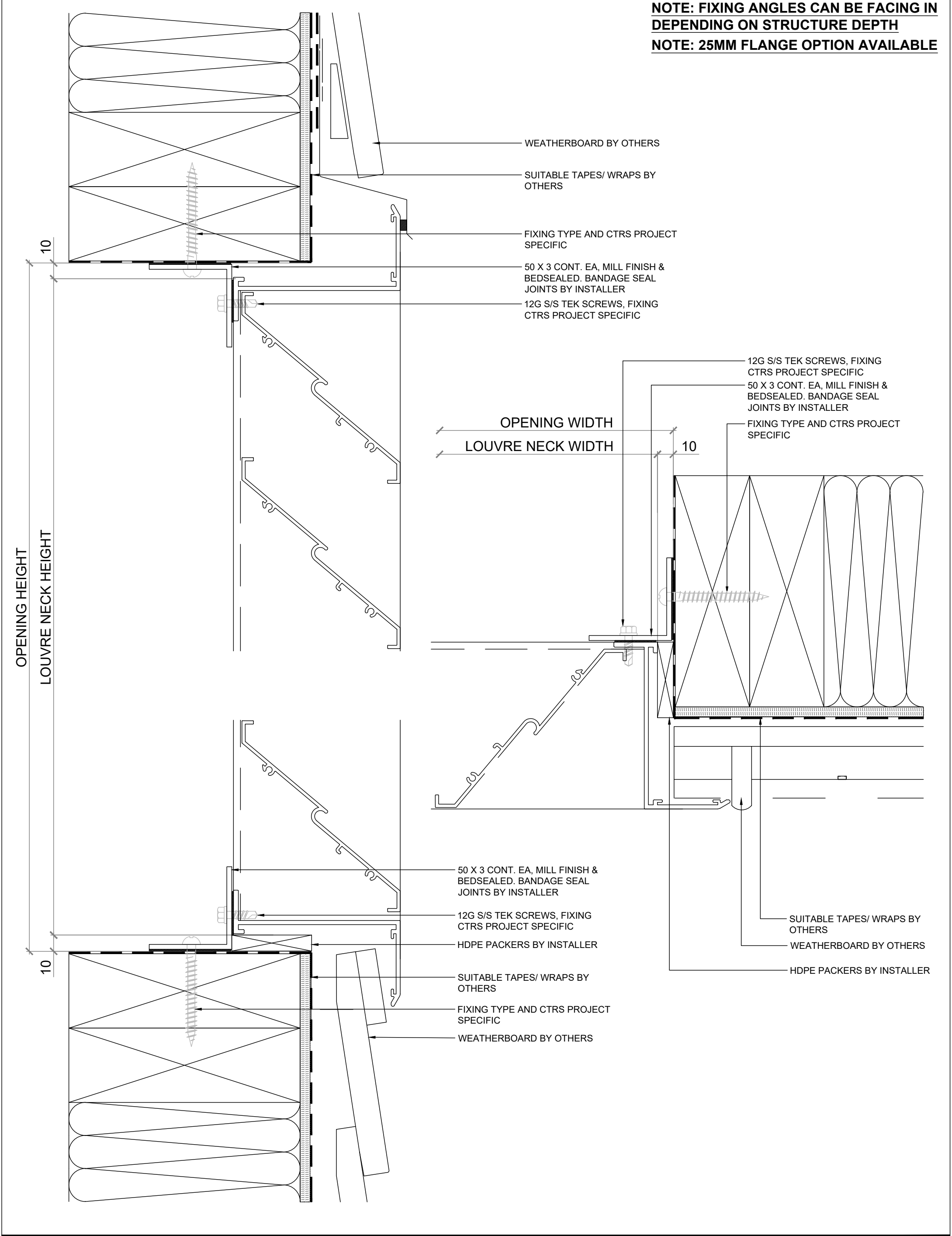

VENTILATION LOUVRE	<div><div>VENTÜER Ventilation, Acoustic & Smoke Louvres</div></div> <div>E: sales@ventuer.co W: ventuer.co</div> <div>© 2019 All rights reserved</div>	SCALE: 1:2 @ A3 - 1:1 @ A4
VL-100S		DWG NO. VL-100S-A.11
INSTALLATION DETAILS WEATHER BOARD		DATE: 15/01/2025
		REV 1