

**NOTE: FIXING ANGLES CAN BE FACING IN  
DEPENDING ON STRUCTURE DEPTH**  
**NOTE: 25MM FLANGE OPTION AVAILABLE**

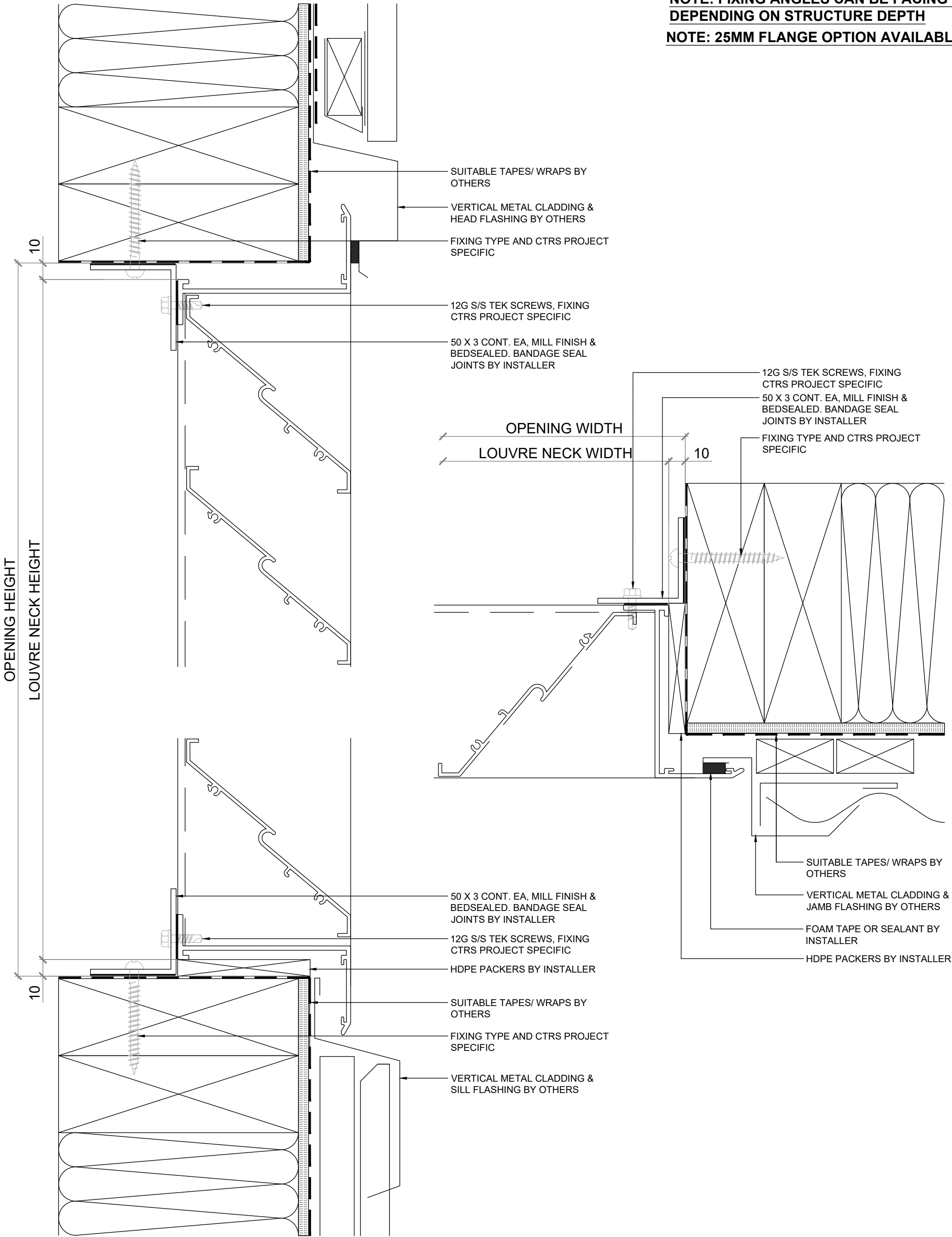

VENTILATION LOUVRE

VL-100S

INSTALLATION DETAILS  
VERTICAL METAL CLADDING



E: sales@ventuer.co  
W: ventuer.co

© 2019 All rights reserved

SCALE: 1:2 @ A3 - 1:1 @ A4

DWG NO. VL-100S-A.05

DATE: 15/01/2025

REV  
1