

# VENTÜER TECHNICAL DATA SHEET

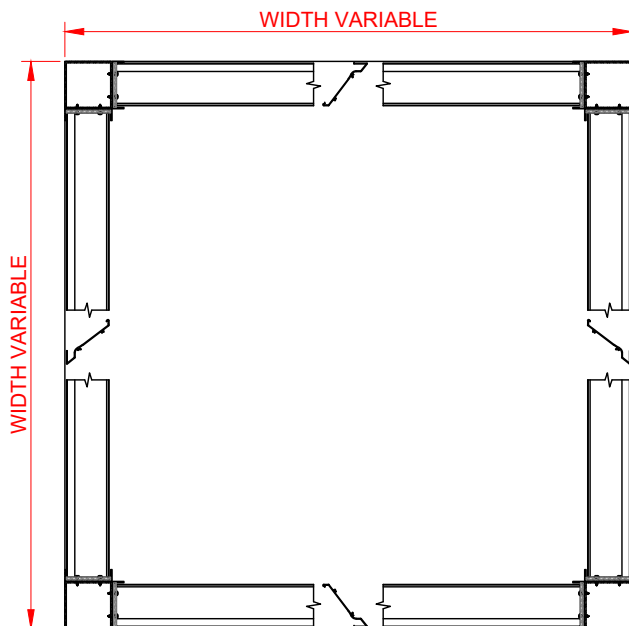

INTERNAL PLAN VIEW

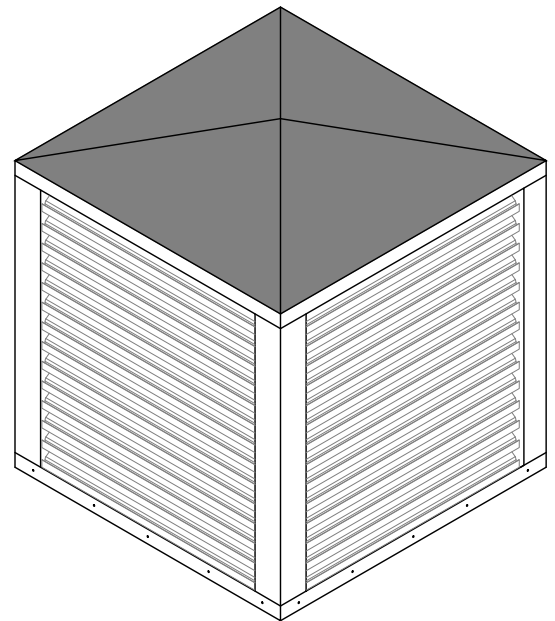

ISOMETRIC

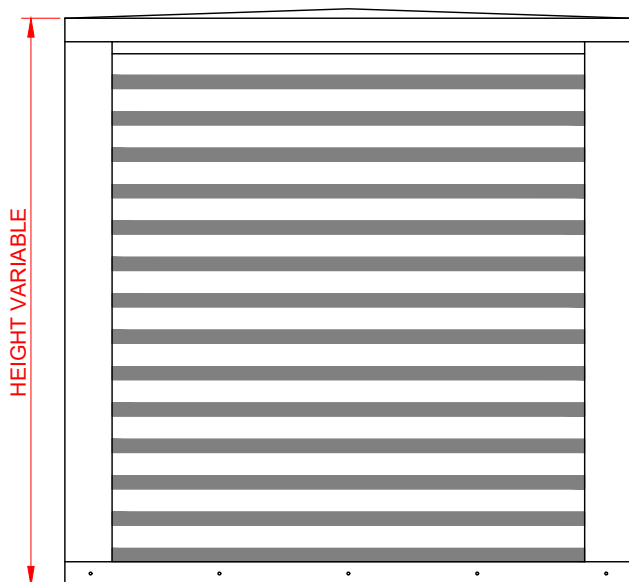

ELEVATION VIEW

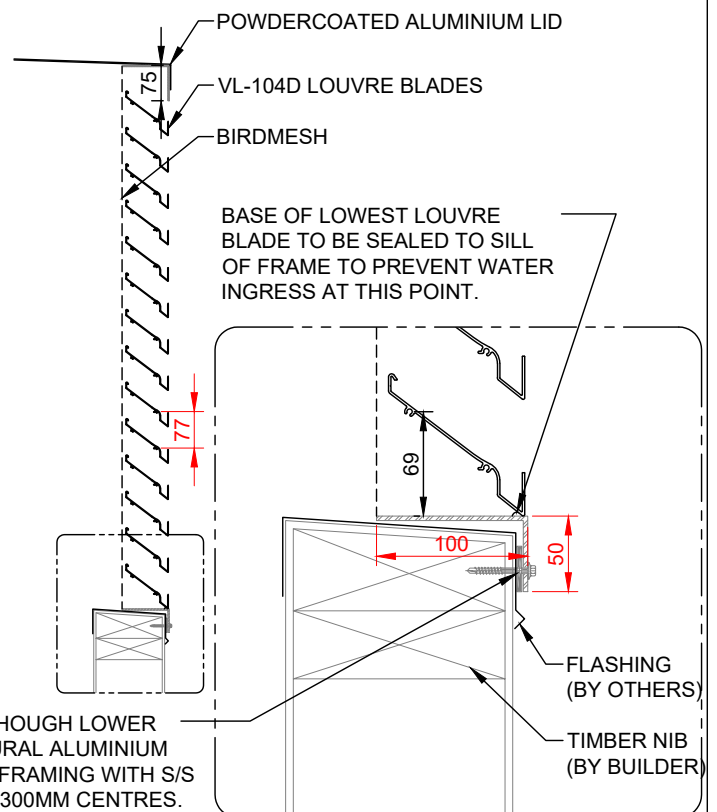

PENTHOUSE FIXED THROUGH LOWER FLANGE OF STRUCTURAL ALUMINIUM FRAME INTO TIMBER FRAMING WITH S/S 14G TEK SCREWS AT 300MM CENTRES. ENSURE MINIMUM 5MM HPDE PACKER BETWEEN FRAME AND CAP FLASHING TO ENABLE CONDENSATION DRAINAGE.

PENTHOUSE LOUVRE

VL-104D PENTHOUSE



**VENTÜER**  
High-Performance Building Ventilation

P: +64 9 973 3616  
W: ventuer.co.nz  
© 2019 All rights reserved

Scale:  
Date:

NTS  
01/08/2023

VL-104D PENTHOUSE

Ver.1